



Special Features

- Easy and rapid installation.
- Half turn locking.
- Cutter size: Ø15mm.
- Flat pack C.K.D. fitting with pre-drilling.
- Cap available for concealed fitting.
- Housing available for 12,16, 18 & 25 mm boards.
- New Steelfix Housing made out of MS is very strong & usable with existing ebco mini fix screws.
- Dowel Pin is push fit in a Ø8mm hole.
- Mini fix screw diecast is available.
- Also Available with double ended bolt and M6 threaded screw with M6 Dowel.
- Rotor Screw is manufactured out of cold forged steel for strength, eliminating chances of breakage.
- The multi-functional plastic enables the screw to be held while fixing with a pneumatic screw driver as well as a perfect fit in the pre-drilled hole.



- Mitre Joint Connectors are ideal for joinery cabinets having Mitre using Minifix.
- Mitre angles from 45° to 90° is possible.
- Split Dowel-Mini fix pin is made out of forged steel for strength. Special grade of plastic for reusability.
- Pin needs to be pushed for inserting and unscrewed for removing.

Specifications

Item	Code No.		Item	Code No.		Item	Code No.	
Steelfix Housing	SF12 ZW		Steelfix Housing	SF16 ZW /NP		Steelfix Housing	SF18 ZW	
Item	Code No.		Item	Code No.		Item	Code No.	
Housing	MF 12		Housing	MF 16		Housing	MF 16(I)N	
Item	Code No.		Item	Code No.		Item	Code No.	
Housing	MF 18		Housing	MF 18(I)N		Housing	MF 25	
Item	Code No.		Item	Code No.		Item	Code No.	
7mm Dia Screw-Eco	MFES7		Ecoscrew-7mmDia	MFES7 (I)		M6 Screw	MFS M6	
Item	Code No.		Item	Code No.		Item	Code No.	
M6 Screw - Eco	MFES M6(I)		7mmDia Screw(I)	MFS 7(I)		Rotor Screw (I)	MFR 7(I)	
Item	Code No.		Item	Code No.		Item	Code No.	
M6 Screw (I)	MFMS6 (I)		Minifix Rotor Screw	MFR 7		M6 Dowel - Ø10	MFD 610	
Item	Code No.		Item	Code No.		Item	Code No.	
M6 Rotor Screw (I)	MFR M6 (I)		Split Dowel - Mini Fix	MFSD 1		Dowel Expando-611	MFDE611(I)	
Item	Code No.		Item	Code No.		Item	Code No.	
M6 Dowel - Ø10 (I)	MFD 610(I)		M6 Dowel - Ø8/Ø8(I)	MFD 608 /608(I)		Mitre Joint Connector	MFMJ44	
Item	Code No.		Item	Code No.				
Cap	MFC 1		Double End Bolt	MFB D 68				



Fitting Instructions

Steelfix Housing 12mm

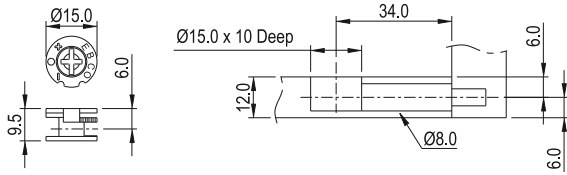

MF 25 for 25mm board

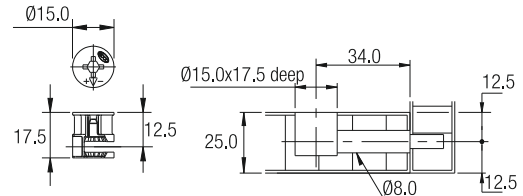

Steelfix SF16, for 16mm to 18mm board

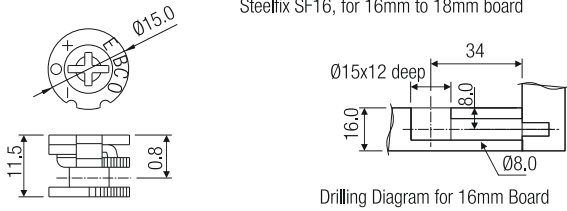

MFSD 1

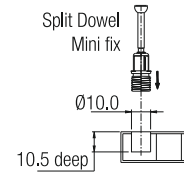

Steelfix Housing 18mm

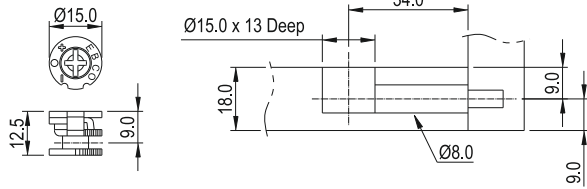

MFS M6()

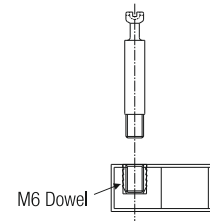

MF 12 for 12mm board

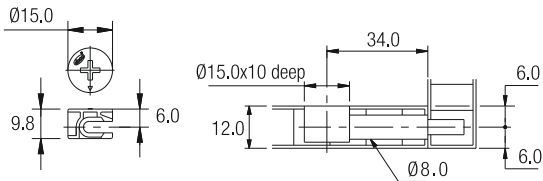

MFES M6()

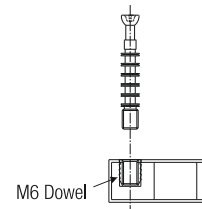

MF 16 for 16mm board

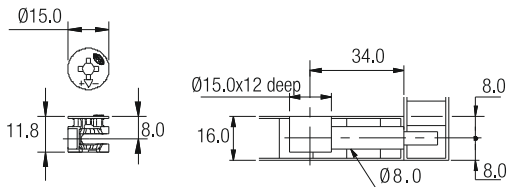

MFR M6()

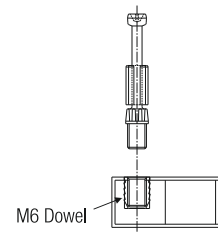

MF 18 for 18mm board

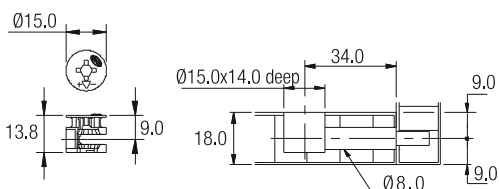

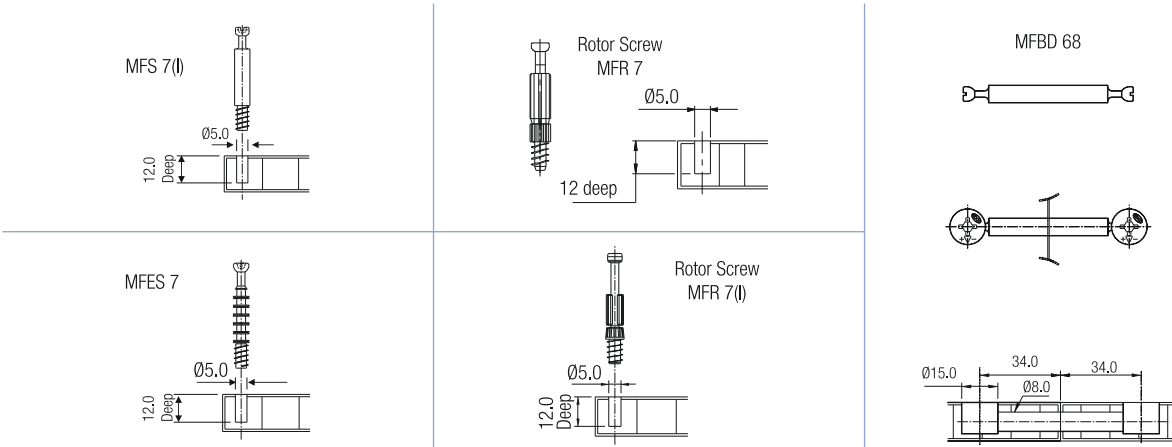

Specifications

Drilling Dimensions for Mitre Joint Connector

Mitre Angle	Board Thickness 'A' (mm)		
	12	16	18
	Inset Distance (mm)		
45°	50.0	52.0	54.0
50°	49.0	50.7	51.6
55°	48.2	49.6	50.3
60°	47.5	48.6	49.2
65°	46.8	47.7	48.2
67.5°	46.5	47.3	47.7
70°	46.2	46.9	47.3

Drilling Dimensions for Mitre Joint Connector

Mitre Angle	Board Thickness 'A' (mm)		
	12	16	18
	Inset Distance (mm)		
75°	45.6	46.1	46.4
80°	45.0	45.4	45.6
85°	44.5	44.7	44.8
90°	44	44	44
'B'	6.0	8.0	9.0
'C'	10.0	12.0	14.0

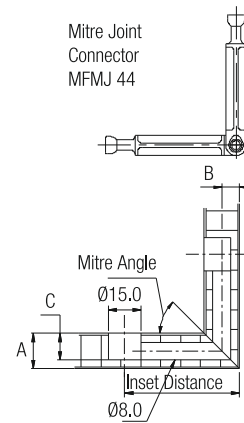

Drilling Diagram for Mitre Joint Connector

Fitting Instructions

