

HINGE SLOW MOTION - 3D

Special Features

- Mounting plate has three way adjustment (3D).
- Unique built in damping system allows the shutter to close in slow motion without banging.
- Available in Full overlay, Half overlay & Inset.
- Max. opening: 105°.
- Max. Shutter size: 34"x22"(850mm x 550mm) for 2 hinges.
- Shutter Thickness: 16mm to 19mm.
- Shutter cavity: Ø35mm, 12 deep, cavity 4mm from edge.



Specifications

Code Nos.	Model	'A' mm	Finish
HSM1-3D	Full Overlay	37	NP
HSM2-3D	Half Overlay	37	
HSM3-3D	Inset	37+S	

S=Thickness of shutter

Fitting Instructions

1. Drill out the cavity in the shutter as per the dimensions in Fig. 1.
2. Fit the cap into the shutter cavity and screw on the hinge at right angle to the edge of the shutter.
3. Mark holes in the cabinet for mounting plate as per Fig.2 and screw on the mounting plate.
4. Now, align the shutter with the cabinet and click-on to the mounting plate. Any play or gap in cabinet can be adjusted in the bracket.
5. By loosening the bracket screws, the shutter can slide horizontally and also be pivoted for varying pressure.

D	K	3	4	5	6	7
Overlay		18	19	20	21	22
Half Overlay		8	9	10	11	12
Inset		0	-1	-2	-3	-4

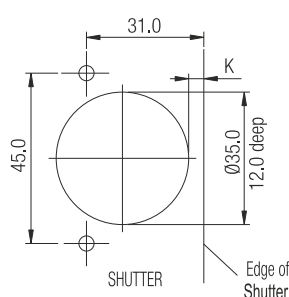

Fig.1

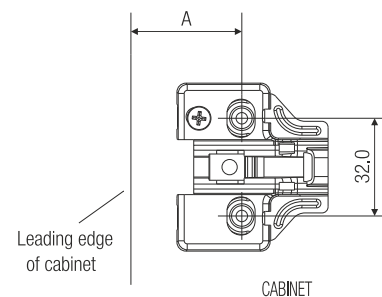
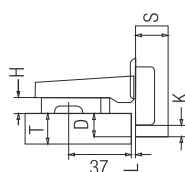
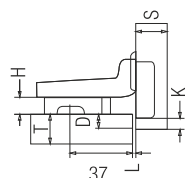

Fig.2

FULL OVERLAY



HALF OVERLAY



INSET

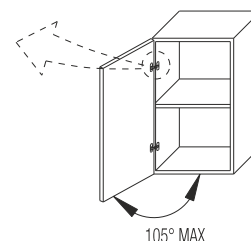
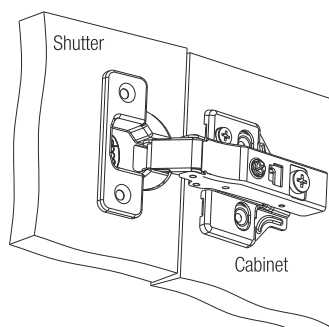
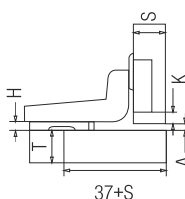

Caution

- For efficiency and durability.
- To avoid damage to hinge, do not force the door to exceed 105°.
 - Do not apply paint or polish.
 - Hinges must be parallel.
 - The hinge must not be hammered.