

MINI HINGE



Special Features

- Available in Full Overlay, Half Overlay & Inset.
- Max. opening : 100°.
- Max. Shutter size : 24" x 18" (600mm x 450mm) for 2 hinges.
- Shutter Thickness : 12mm to 18mm.
- Shutter cavity : Ø26mm, 10mm deep, 4mm from edge.



Specifications

Code Nos.	Model	'A' mm	Finish
HM1	Full Overlay	37.0	NP
HM2	Half Overlay	37.0	
HM3	Inset	37+S	

S=Thickness of shutter

Fitting Instructions

1. Drill out the cavity in the shutter as per the dimensions in Fig. 1.
2. Fit the cap into the shutter cavity and screw on the hinge at right angle to the edge of the shutter.
3. Mark hole in the cabinet for mounting plate as per Fig. 2 and screw on the mounting plate.
4. Now, align the shutter with the cabinet and slip-on and screw the hinge on to the mounting plate. Any play or gap in cabinet can be adjusted in the bracket.
5. By loosening the bracket screws, the shutter can slide horizontally and also be pivoted for varying pressure.

D	K	3	4	5	6
Overlay		13	14	15	16
Half Overlay		4	5	6	7
Inset		2	1	0	-1

FULL OVERLAY

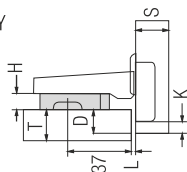

HALF OVERLAY

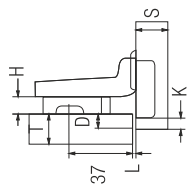

INSET

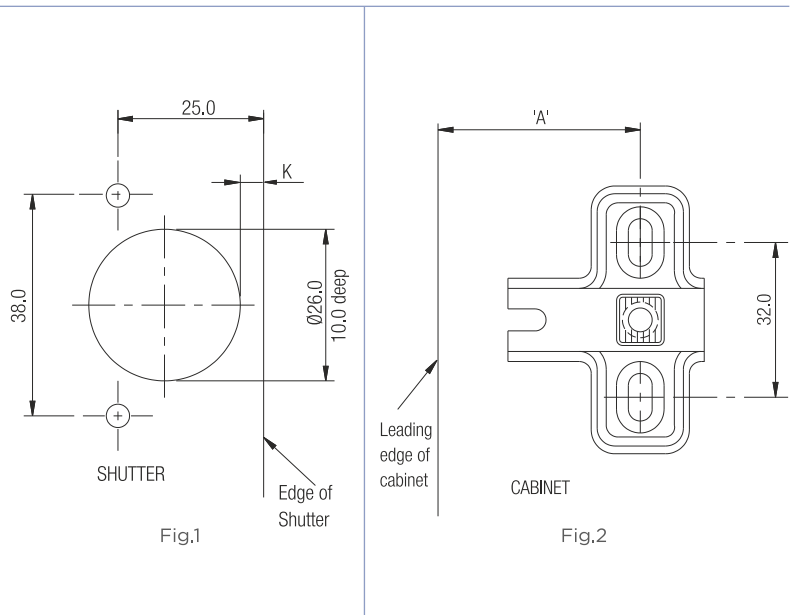
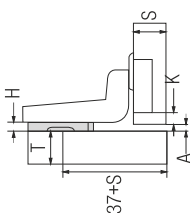

Caution

- For efficiency and durability.
- To avoid damage to hinge, do not force the door to exceed 100°.
 - Do not apply paint or polish.
 - Hinges must be parallel.
 - The hinge must not be hammered.

