



DOOR CLOSER - DC 301-B



Special Features

- Latching and Closing speed adjust valve.
- Right hand and left hand opening door.
- Door width 900-1200mm.
- Door weight 105kgs.
- Door opening angle of 180° max.
- 5,00,000 cycles tested.



Specifications

Item Code No.	Body Size in mm			Hold Open Facility	Latching and Closing Speed Adjust Valve	Technical Parameter	
	L	W	H			Door Width	Door Weight
DC 301-B	206	45	67	No	Available	900 - 1200mm	105kgs

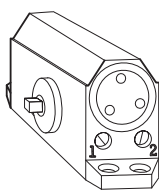
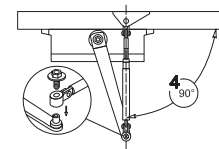
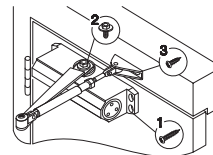
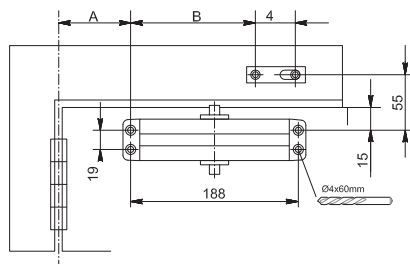
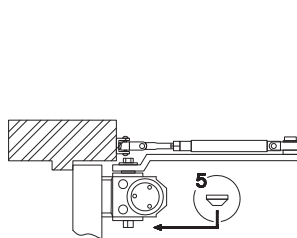
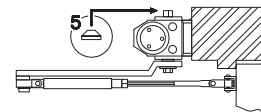
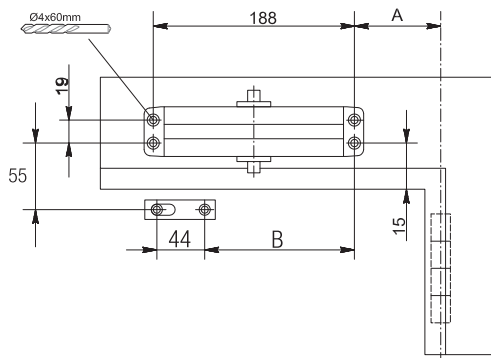
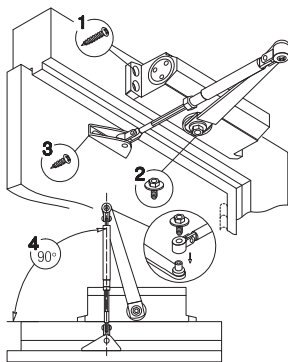

1 - control 180-20 closing speed
2 - control 20-0 latching speed

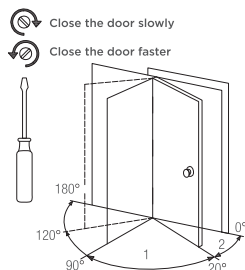

Warning users:

1. Do not turn speed regulating valve exceed the maximum turns, avoid oil leakage, it can lead to run instability.
2. Let the door closer close by itself, please do not add external forces, or it may damage the door closer.
3. Please read this instruction carefully before installation. we won't be responsible for any results which are caused by the wrong mounting ways.

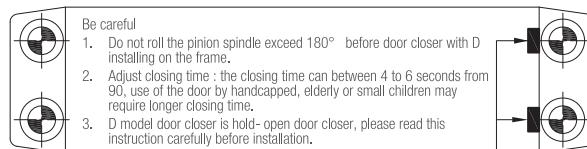

Be careful

1. Do not roll the pinion spindle exceed 180° before door closer with D installing on the frame.
2. Adjust closing time : the closing time can between 4 to 6 seconds from 90, use of the door by handicapped, elderly or small children may require longer closing time.
3. D model door closer is hold - open door closer, please read this instruction carefully before installation.

Speed regulating valves toward hinge.